

GRAPHTEC

FCX4000 SERIES

LOW-COST • PRECISE • DIE-FREE CUTTING & PROCESSING



Graphtec FCX4000

is an affordable cutting solution for small to medium print on demand jobs - using electrostatic to hold media. The 60ES model cleanly fits four A3+ sheets for high productivity. Operation is intuitive with its new control panel, 3.7" LCD screen, and USB / barcode functionality.

AFTER PRINTING

1



Cut and crease printed material.
Suitable for small/medium production

2



POP, package, business cards,
labels, heat transfer apparel & more.



up to
Tool 1 600 gf
Tool 2 600 gf

MAX. CUTTING FORCE



up to
W 976 mm
H 660 mm

MAX. CUTTING AREA



Features

USB OFFLINE OPERATION & BAR-CODE FUNCTION

Cut & plot data is created with Cutting Master 4 or Graphtec Pro Studio and saved to USB flash drive. For USB operation, the file can be selected from the control panel of the cutting plotter. The corresponding cutting conditions are loaded and the FCX4000 processes the job automatically without a PC connection. When operating with a printed barcode, the cutter reads, sets, conditions, and processes the job.

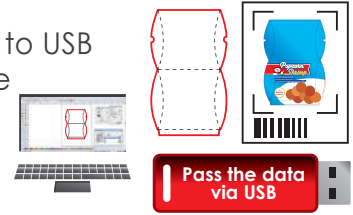

DUAL TOOL HOLDERS & CURVED CREASING LINE

DUAL TOOL HOLDERS - cut and crease in the same run.

CURVED CREASING TOOL - create curved creasing lines on packaging.

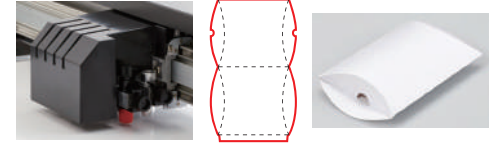

ARMS 6.0 FUNCTION

Graphtec's renowned advanced registration mark sensing system produces highly accurate print & cut results - even on challenging materials such as high-gloss and high-intensity-reflective.

	FCX4000-50ES	FCX4000-60ES
Effective Cutting Area	660 mm x 488 mm	976 mm x 660 mm
Unit Dimensions (includes stand)	W 1089 x D 987 x H 204 mm	W 1405 x D 1097 x H 896 mm

Specifications

Max. Cutting Speed	750 mm / sec	Features	Added Function: multiple marks compensation with one mark, support multi-mark origin movement, mark origin function, support Illustrator crop mark, expanding cutting area, ISM, reverse-side cutting/creasing, pressing mechanism for media Other Functions: axis alignment in 2/3/4-point, multiple mark compensation, segment area compensation, auto mark detection, auto expansive adjustment, copy with registration mark.
Cutting Force	Tool 1: Max. 600 gf Tool 2: Max. 600 gf		
Distance Accuracy	Max. 0.2% of the distance moved or 0.1 mm, whichever is larger (in plotting mode)*		
Repeatability	Max. 0.1 mm (excluding contraction of media, in plotting/cutting mode)* * operated with Graphtec specified media and conditions.		
Interface to PC	USB2.0 full-speed / Ethernet / RS-232C	Compatible OS	Win 10/8.1/8/7, Mac 10.7-10.13.1
Command Sets	GP-GL™, HP-GL® / Auto (automatic switching in GP-GL™ and HP-GL®)	Warranty	1-Yr parts & labor warranty
Operating Panel	3.7" graphical LCD (same as FCX2000)	TYPE OF MEDIA	
Standard Software	Graphtec Pro Studio (for Wins), Graphtec Studio (for Mac), Cutting Master 4 (Win/Mac)	Self-adhesive marking film (vinyl, fluorescent, reflective) Stiff paper/card (for stencils, etc) Polystyrene foam Sandblast rubber sheets	
Optional Software	Graphtec Pro Studio Plus	Micro flute board (F/G grades) Clear sheets for plastic boxes High-intensity reflective film for materials that can not be held down by electrostatic, it is required to use the optional cling mat or adhesive sheet.	
New Features	Dual configuration, creasing in the curve, perforation cutting, data management using bar-code, offline cutting operation using USB memory, confirming the cutting object size, draft mode.		

Accessories

Standard Accessories (included)	Printed docs: quick guide, safety & cutting blade manual Blade: CB15U-1 (1 pc/pack) Blade-holder: PHP35-CB15-HS Loupe: PM-CT-001, for checking blade length Fiber-tip pen: KF700-BK (Black) & PHP31-FIBER (pen-holder) Power cable, USB cable 2.9 m Protection sheet*: PM-CR-002 for FCX4000-50ES, PM-CR-003 for FCX4000-60EA. Transparent vinyl, thickness 0.3 mm	Blade-Holder	PHP33-CB09N-HS, PHP33-CB15N-HS, PHP35-CB09-HS, PHP35-CB15-HS
		Fiber-Tip Pen	KF700-BK (black), KF700-RD (red), KF700-BL (blue)
		Pen Holder	PHP31-FIBER, for KF700 series
		Creasing Tool	CP-001: stick style, 1 mm tip PM-CT-002: ball on tip of stick style, 1.5 mm dia
		Loupe	PM-CT-001 for checking the length of the extruded blade tip
		Cling Mat	PM-CM-001 (TBA) for film based type material, size 26" x 19" PM-CM-002(TBA) for paper based type material, size 26" x 19"
		Adhesive Sheet	CM-0003-R1A, adhesive sheet (double-sided adhesive coated sheet), size 21.4" x 65" 7.4" (supplying in roll)
Blade	CB09UB-5, CB15U-5, CB15U-K20-2SP, CB15U-K30-5, CB15UA-5, CB15UA-K30-5	Protect Sheet	PM-CR-002 for FCX4000-50ES transparent vinyl, thickness 0.3 mm, PM-CR-003 for FCX4000-60ES transparent vinyl, thickness 0.3 mm

- Brand names and product names listed in this brochure are the trademarks or registered trademarks of their respective owners.
- Items mentioned are subject to change without notice. For more information about product, please check the web site or contact your local representative.

⚠ For safe operation of equipment • Before use, please read the user manual and operate properly in accordance with the description.
• To avoid malfunction or an electric shock by current leakage or voltage, please ensure a ground connection and use according to the specification.

astragraphia

member of ASTRA



Halo Astragraphia

1500 345

www.DocumentSolution.com

Let's Be Friends ☺



astragraphia document solution



@astragraphia_ds



@astragraphiadocsol